

**OUR APARTMENTS:**

One Bedroom (142 units)

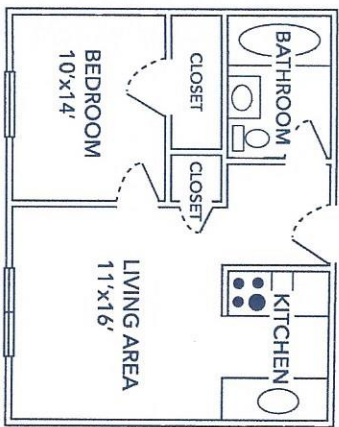

Efficiency (23 units)

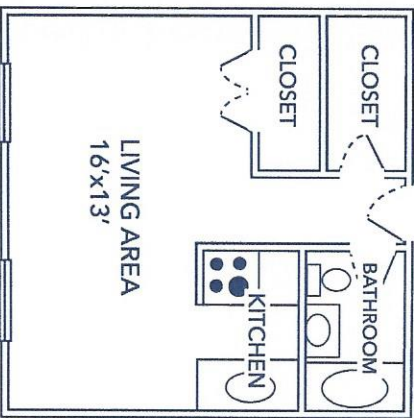

**FEATURES:**

- 142 one-bedroom units and 23 efficiencies (see floor plans above)
- Ample closet space
- Ceramic tile baths
- Emergency call devices available
- Individually controlled heat and air conditioning
- Modern kitchen appliances
- Wall-to-wall carpeting
- Cable-television ready

**Belvedere Green**  
1651 East Belvedere Ave.  
Baltimore, MD 21239  
410-433-7255 PHONE

**Woodbourne Woods**  
1650 Woodbourne Ave.  
Baltimore, MD 21239  
410-433-7255 PHONE

Residents have the right to receive care regardless of race, creed, sex, national origin, sources of payment for care, or whether they have formulated an advance directive.

- MedStar Franklin Square Medical Center
- MedStar Georgetown University Hospital
- MedStar Good Samaritan Hospital**
- MedStar Harbor Hospital
- MedStar Montgomery Medical Center
- MedStar National Rehabilitation Network
- MedStar Southern Maryland Hospital Center
- MedStar St. Mary's Hospital
- MedStar Union Memorial Hospital
- MedStar Washington Hospital Center
- MedStar Family Choice
- MedStar Medical Group
- MedStar PromptCare
- MedStar Visiting Nurse Association
- MedStar Institute for Innovation
- MedStar Health Research Institute

**MedStarGoodSam.org/SeniorLiving**



**MedStar Good Samaritan  
Hospital**

5601 Loch Raven Blvd.  
Baltimore, MD 21239  
443-444-8000 PHONE

17-MGSH-0952.092017



**MedStar Good Samaritan  
Hospital**



**Senior Housing and  
Supportive Services**

Independent living apartments for people who are 62 and older



SENIOR HOUSING  
OPERATIONS

Knowledge and Compassion  
**Focused on You**

Sponsored and managed by MedStar Good Samaritan Hospital, Belvedere Green and Woodbourne Woods provide many features for the care and comfort of residents.

Spacious rent-subsidized apartments include all the services you would expect, as well as extra amenities.

Because of the close affiliation with MedStar Good Samaritan, Belvedere Green and Woodbourne Woods residents can also depend on expert medical care right next door.

**REQUIREMENTS:**

- At least 62 years of age
- Handicapped/disabled
- Able to live independently without assistance
- Meet HUD income limits

**RENT: AN EQUAL HOUSING OPPORTUNITY**

- All units are rent subsidized.
- Residents pay only 30 percent of adjusted gross income.

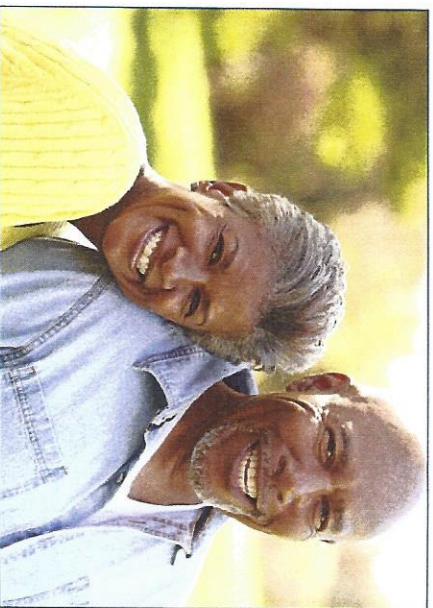

**SERVICES AND AMENITIES:**

- 24-hour staffed security
- Accessible bus transportation
- Beauty salon/barber services
- Coin-operated laundry
- Dining/multi-purpose area
- Greenhouse
- Nearby shopping and churches
- Nutrition program
- Outdoor patio
- Wellness program
- Gardening
- Daily activities
- Religious services
- Transportation provided for regularly scheduled shopping trips
- Medical transportation provided to MedStar Good Samaritan Hospital and its doctors' offices on campus
- Supportive services
- Social work consultation
- Assistance with healthcare needs, including educational programs, healthcare screenings and medication schedules
- Opportunities for individual and group activities

**SUPPORT SERVICES:**

The MedStar Good Samaritan Hospital Senior Supportive Services program is a package of services offered to the residents of Belvedere Green and Woodbourne Woods apartments.

The program is designed to assist residents that may experience periodic difficulty with the essential activities of daily living. To gain complete information about an applicant's areas of need, it is requested that the applicant participate in a psychosocial assessment and receive a current medical evaluation from a physician.

The goal of the Senior Supportive Services program is to allow residents to continue living in an independent setting by providing personalized support services, ensuring proper nutrition, encouraging socialization, and assisting with regular monitoring of health and medical conditions.

**INDIVIDUALIZED SERVICES INCLUDE:**

- Two meals a day, seven days a week, served in the dining room
- A minimum of 1.5 hours of housekeeping each week, which includes vacuuming, dusting, mopping, etc.
- A minimum of 1.5 hours of personal care each week, which includes assistance with bathing, dressing and grooming as needed
- A minimum of 1.5 hours of laundry service each week

The maximum monthly cost of the program is based upon income as determined by the State Office on Aging. The fee may be subsidized by the Maryland Office on Aging, depending on the participant's income. Exact program fees cannot be determined until all income information has been reviewed.

For complete details about availability and our exceptional services, call the housing administrator at **410-433-7255**.