

## **COVID-19: MedStar Health Community Vaccine Locations**

### **MedStar Georgetown University Hospital**

#### **Community Vaccination Center: Martin Marietta Conference Room**

3800 Reservoir Rd., NW

Lombardi Lower Level

Washington, DC 20007

#### **Driving Directions**

- **From Northwest Washington**

- Take Wisconsin Avenue south to Reservoir Road. Turn into MedStar Georgetown Entrance 2 (Emergency Department) and park in the patient and visitor parking garage.

- **From Southeast Washington**

- Take Pennsylvania Avenue west to Independence Avenue. Bear left. Take Independence to 12th Street, NW and turn right. Take 12th Street to K Street and turn left. Follow K Street to Whitehurst Freeway. Turn left onto Canal Road. Stay in right lane. Bear right onto Foxhall Road. Turn right at Reservoir Road. Turn into MedStar Georgetown Entrance 2 (Emergency Department) and park in the patient and visitor parking garage.

- **From Northeast Washington**

- Take Rhode Island Avenue west until it feeds into M Street. Take M Street to Wisconsin Avenue. Turn right onto Wisconsin Avenue. Take Wisconsin Avenue to Reservoir Road. Turn into MedStar Georgetown Entrance 2 (Emergency Department) and park in the patient and visitor parking garage.

**Once parked at MedStar Georgetown**, enter the main entrance of the hospital to check in and be screened. Staff will be present to direct you to the Martin Marietta Conference Room which is a short walk from the main entrance. Wheelchairs will be available for those with limited mobility.

#### **Ride-hailing Services (Uber/Lyft/Taxi)**

- Choose your destination as 3800 Reservoir Rd., NW (Entrance 2).
- Drop off (and pick up) is located at the West Wing circle on your left as your vehicle enters the hospital campus.
- Enter the main hospital to check in and be screened. Staff will be present to direct you to the Martin Marietta Conference Room which is a short walk from the main entrance. Wheelchairs will be available for those with limited mobility.

#### **Metrobus**

- The D6 Metrobus stops directly in front of the hospital on Reservoir Road.
- Depart the bus and go toward Entrance 2 (Emergency Department).

- Do not go into the Emergency Department – go to your left and enter the main hospital.
- Enter the main hospital to check in and be screened. Staff will be present to direct you to the Martin Marietta Conference Room which is a short walk from the main entrance. Wheelchairs will be available for those with limited mobility.

### **Metrorail**

- Take the Red Line to Dupont Circle.
- Georgetown University provides free shuttle service between the Dupont Metro station and the University campus. The shuttle buses are branded as “Georgetown University” or “International Limo.”
- The shuttle buses run Monday through Friday from 5:30 a.m. to 11:45 p.m. Buses depart every 15 minutes during peak hours of 6:30 a.m.- 9:30 a.m. and 3:30 p.m.- 6:30 p.m. At other times departures occur every 30 minutes.
- The shuttle bus stop at the Dupont Metro station is at Massachusetts Avenue and 20th Street.
- The shuttle buses enter the Georgetown University campus via Canal Road and pick up and drop off passengers in the shuttle bus loop by the Southwest Quad and McDonough Gym.
- To assist people getting from the shuttle bus loop to MedStar Georgetown University Hospital, a 10-seat, open-air, mini shuttle bus is available. The mini shuttle bus takes passengers from the shuttle bus loop to the entrance of the Lombardi Comprehensive Cancer Center.
- Enter the Lombardi Comprehensive Cancer Center and approach the check in desk to be screened. The Martin Marietta Conference Room is directly opposite the check in desk.

### **MetroAccess and Paratransit Services**

- All MetroAccess and paratransit providers are to enter the hospital campus at Entrance 2.
- Drop off (and pick up) is located at the West Wing circle on your left as your vehicle enters the hospital campus.
- Enter the main hospital to check in and be screened. Staff will be present to direct you to the Martin Marietta Conference Room which is a short walk from the main entrance.

## MedStar Washington Hospital Center

### Community Vaccination Center: Physician Office Building, Room 121

106 Irving St. NW

POB Room 121

Washington, DC 20010

### Parking

There are several parking options at MedStar Washington Hospital Center. The parking lot closest to the Community Vaccination Center is the Physician Office Building (POB) parking lot. The parking lot can be accessed from 1<sup>st</sup> Street NW and Hospital Center Drive. A campus map with parking highlighted is below.

For more parking information visit [MedStarWashington.org/Parking](https://www.MedStarWashington.org/Parking).

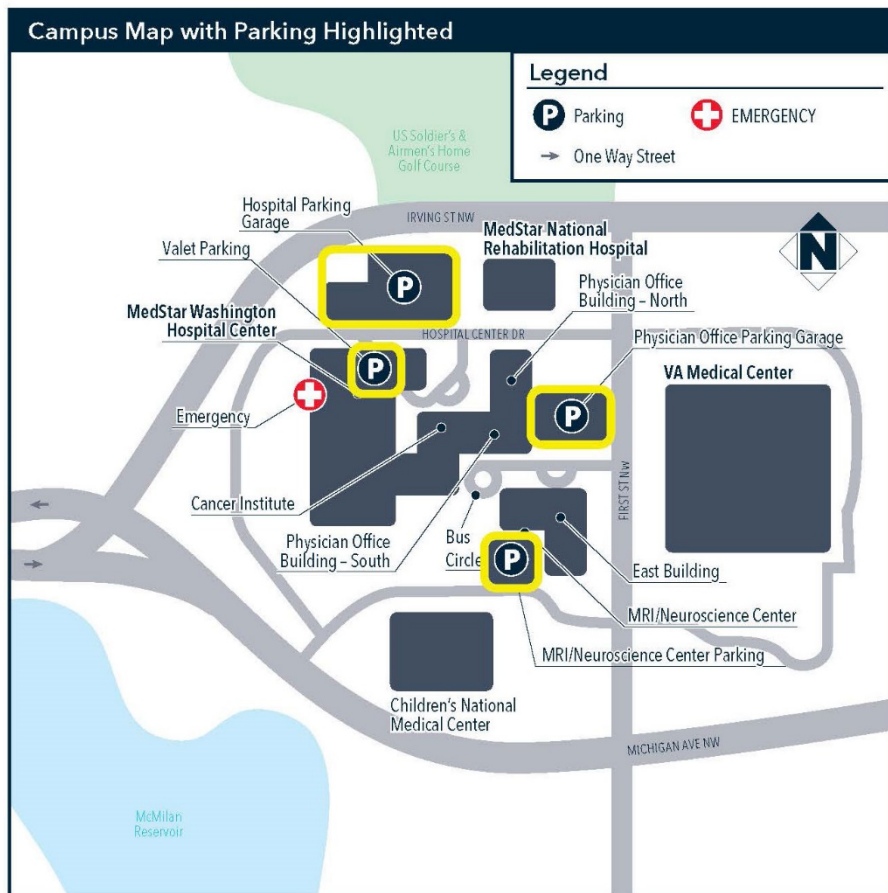

### Public Transportation

WMATA has three metrobus routes that service our campus - H2, H4 and D6. For more information about Metrobuses, please contact WMATA at 202-637-7000 or visit the Washington Metropolitan Area Transit [website](#).

Additionally, MedStar Health provides free, wheelchair-accessible shuttle buses from two Metrorail stations: Brookland/CUA on the Red line and Columbia Heights on the Green/Yellow lines. Note that these shuttles run Monday - Friday and do not operate on weekends or holidays.

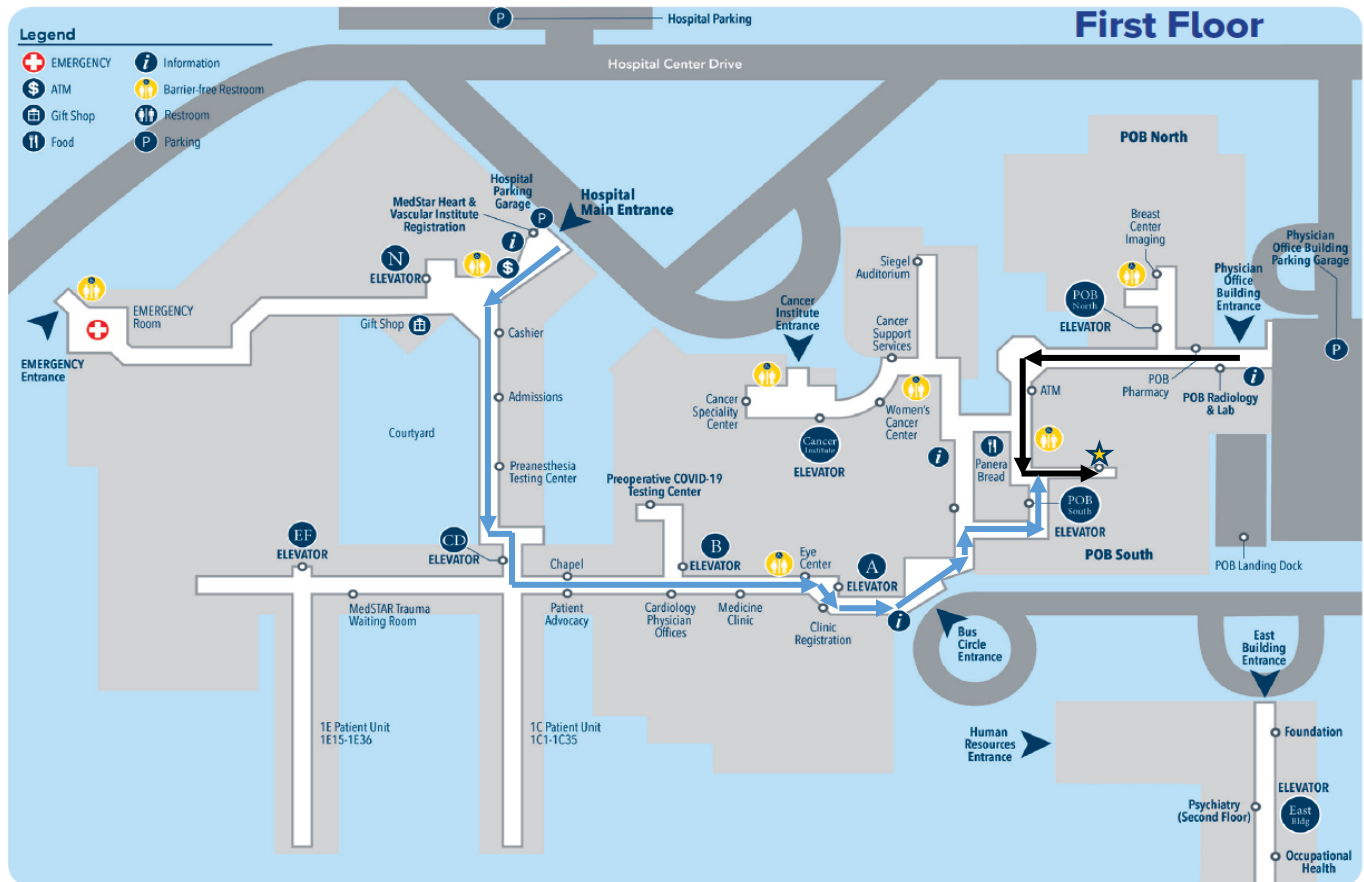

**From the Hospital Main Entrance (blue line, top entrance)**

- Turn left and follow the signs to the Bus Circle. Pass Admissions on your left.
- Continue straight to the end of the hallway. At the C/D elevators turn left in the Main Corridor.
- Continue straight and follow the ramp toward the POB South Tower.
- Turn right at the first hallway; then an immediate left, pass the elevators on your left.
- Turn right at the next hallway. POB 121 Community Vaccination Center is on the left.

**From the Bus Circle Entrance (blue line, bottom entrance)**

- Turn right and pass the Information Desk on your left.
- Follow the hallway around; make a right at the first hallway, then an immediate left. Pass the elevators on your left.

- Turn right at the next hallway. POB 121 Community Vaccination Center is on the left.

### **From the Physician Office Building Entrance (black line)**

- Turn right and follow hallway into the atrium.
- Turn left and continue straight.
- With Panera Bread on your right, turn left into the hallway. POB 121 Community Vaccination Center is on the left.

### **Driving Directions**

- **From Downtown Washington**

- Go north on 16th Street, NW. Turn right at Irving Street, NW. Follow Irving Street as it bears to the left around the back of the MedStar Washington Hospital Center campus. Turn right at First Street, NW. Follow signs to parking in the **Physicians Office Building Garage**.

- **From Northern Virginia via Arlington Memorial or Theodore Roosevelt Bridges**

- Follow the George Washington Parkway to Arlington Memorial or Theodore Roosevelt Bridge. From Memorial Bridge, bear left around the Lincoln Memorial and take the second left onto Constitution Avenue. From Roosevelt Bridge, after crossing the bridge, it turns into Constitution Avenue. Follow Constitution Avenue for 2.2 miles and turn left onto Louisiana Avenue, NW. At the fourth light, turn left onto North Capitol Street. Follow North Capitol Street north about 2.5 miles to the Hospital Center exit (Irving Street, West). Turn left at the first traffic light onto the Washington Hospital Center campus. Follow signs to parking in the **Physicians Office Building Garage**.

- **From Northern Virginia via 14th Street Bridge Follow I-395 across the 14th Street Bridge continuing eastward.**

- Take right side exit toward the U.S. Capitol and follow the tunnel to its end at New York Avenue, NW. Turn right at New York Avenue, bearing right immediately onto M Street, NW. Continue three blocks to North Capitol Street. Turn left onto North Capitol Street and proceed north for about two miles (past Michigan Avenue) and exit at Irving Street, West. Turn left at the first traffic light onto the MedStar Hospital Center campus. Follow signs to parking in the **Physicians Office Building Garage**.

- **From Montgomery County via Wisconsin or Connecticut Avenues**
  - Take Wisconsin or Connecticut Avenue to the Friendship Heights/Chevy Chase area. From Wisconsin Avenue, turn left on to Western Avenue, then turn right at the first light, Military Road. From Connecticut Avenue, turn left on Military Road. Travel east through Rock Creek Park, continuing beyond Georgia Avenue (where Military Road turns into Missouri Avenue). Continue along Missouri Avenue for 1.3 miles to North Capitol Street. Turn right on North Capitol Street and travel south for 1.5 miles to the Irving Street, West exit. While exiting, stay to the left. At the traffic light, turn right on Irving Street. Turn left at first traffic light onto the MedStar Washington Hospital Center campus. Follow signs to parking in the **Physicians Office Building Garage**.
- **From Baltimore/I-95 Take I-95 south to I-495 west (Capital Beltway) towards Silver Spring.**
  - Take first exit at New Hampshire Avenue, South. Follow New Hampshire Avenue for 4.6 miles. Turn left onto North Capitol Street and go 1.8 miles to Washington Hospital Center exit (Irving Street, West). While exiting, stay to the left. At the traffic light, turn right on Irving Street. Turn left at first traffic light onto the MedStar Washington Hospital Center campus. Follow signs to parking in the **Physicians Office Building Garage**.
- **From Baltimore/I-295 Take Baltimore/Washington Parkway (I-295) south to Washington.**
  - Exit to the right onto South Dakota Avenue. Follow South Dakota Avenue for 1.4 miles to Monroe Street. Turn left on Monroe Street and follow 1.3 miles to end at Michigan Avenue. Turn left onto Michigan Avenue. After crossing North Capitol Street intersection, take a right at the light on First Street, NW. Turn left at the second stop sign (flashing traffic light) onto the MedStar Washington Hospital Center campus. Follow signs to parking in the **Physicians Office Building Garage**.
- **From Annapolis, Southern Prince George's County, Anne Arundel County or Calvert County**
  - Take U.S. Route 50, west into Washington, D.C. (Route 50 becomes New York Avenue). Take the South Dakota Avenue exit and proceed 1.4 miles to Monroe Street. Turn left on Monroe Street and proceed for 1.3 miles to end at Michigan Avenue. Turn left onto Michigan Avenue. After

crossing North Capitol Street intersection, turn right at first traffic light onto First Street, NW. Turn left at the second stop sign (flashing traffic light) onto the MedStar Washington Hospital Center campus. Follow signs to parking in the **Physicians Office Building Garage**.

- **From Greenbelt/College Park/Hyattsville Area**

- Follow Queens Chapel Road west through Hyattsville where it turns into Michigan Avenue. Continue on Michigan Avenue past the Basilica of the National Shrine of the Immaculate Conception and through the North Capitol Street intersection. Turn right at the first traffic light on Irving Street, NW. Turn left at the second stop sign (flashing traffic light) onto the MedStar Washington Hospital Center campus. Follow signs to parking in the **Physicians Office Building Garage**.

## MedStar National Rehabilitation Hospital

### Community Vaccination Center: MNRH Auditorium, Ground Floor

102 Irving St. NW

Auditorium, Ground Floor

Washington, DC 20010

### Parking

The parking lot closest to the Community Vaccination Center at MedStar National Rehabilitation Hospital is the (Blue) Hospital Parking Garage; however the (Yellow) Hospital Parking Garage, located directly across from the hospital, is also easily accessible and available to use. Both Yellow and Blue parking garages can be accessed from 1<sup>st</sup> Street NW and Hospital Center Drive. A campus map with parking highlighted is below.

For more parking information visit: <https://www.medstarnrh.org/for-patients/patients-and-visitors/directions-maps-and-parking/parking/>

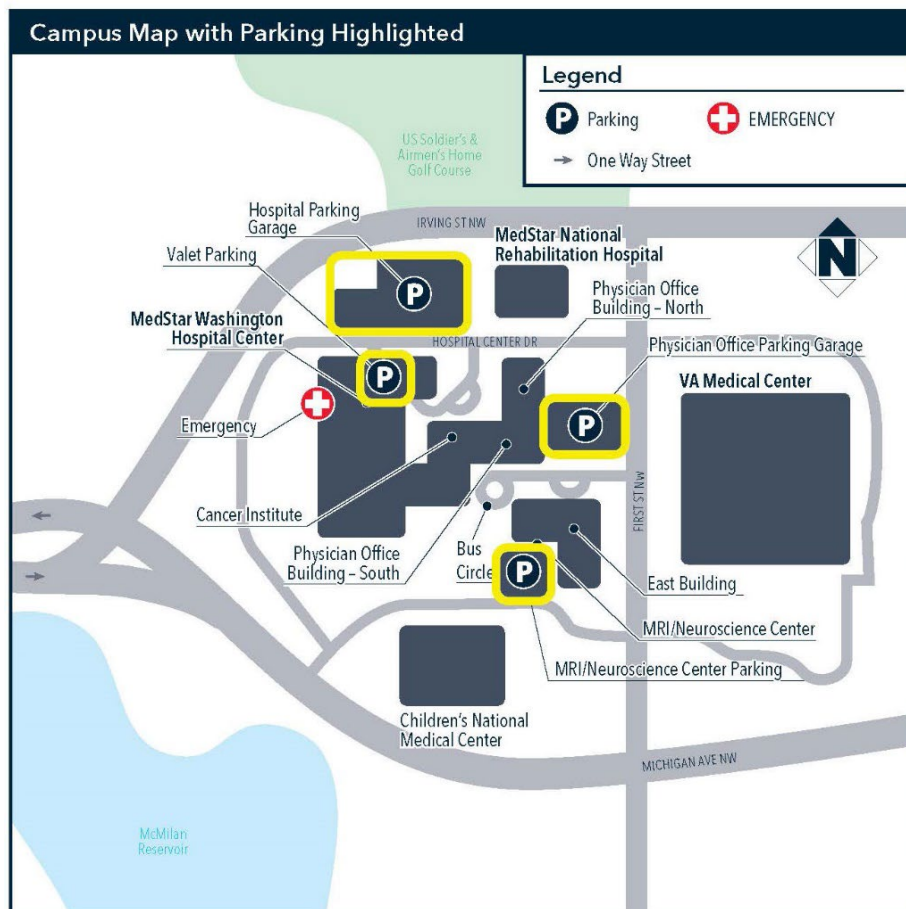

### Public Transportation

WMATA has three metrobus routes that service our campus - H2, H4 and D6. For more information about Metrobuses, please contact WMATA at 202-637-7000 or visit the Washington Metropolitan Area Transit [website](#).



Additionally, MedStar Health provides free, wheelchair-accessible shuttle buses from two Metrorail stations: **Brookland/CUA** on the Red line and **Columbia Heights** on the Green/Yellow lines. Please Note:

- Operates Monday-Friday
- Does not operate on weekends or holidays
- Metro shuttles pick up and drop off passengers at the Veterans Medical Center, MedStar National Rehabilitation Hospital and the MedStar Washington Hospital Center.
- Shuttle schedules here: [Brookland/CUA](#) and [Columbia Heights](#)

### **From the Hospital Main Entrance**

- Enter through the main entrance of the hospital.
- After checking-in, use the West Side elevators on the left, and press the 'Ground Floor' button on the elevator to go down.
- When the elevator opens on the ground floor, walk forward and the entrance to the Vaccination Clinic will be on the right, (the vaccination clinic is located inside of the NRH Auditorium).
  - Directional signage and hospital associates will be available to help direct you to the clinic.

### **Driving Directions**

- **From Downtown Washington**
  - Go north on 16th Street, NW. Turn right at Harvard Street until it ends at the McMillan Reservoir. Turn left at the light onto Michigan Avenue. The reservoir will be on your right. After passing Children's National Medical Center, turn left at the light onto First Street, NW.
- **From Northern Virginia via Arlington Memorial or Theodore Roosevelt Bridges**
  - Follow the George Washington Parkway to Arlington Memorial or Theodore Roosevelt Bridge. From Memorial Bridge, bear left around the Lincoln Memorial and take the second left onto Constitution Avenue. From Roosevelt Bridge, after crossing the bridge the road becomes Constitution Avenue. Follow Constitution for 2.2 miles and turn left onto Louisiana Avenue, NW. At the fourth light, turn left onto North Capitol Street. Follow North Capitol Street north about 2.5 miles to the Irving Street exit. Turn left at the first light onto the hospital campus.
- **From Northern Virginia via 14th Street Bridge**
  - Follow I-395 across the 14th Street Bridge continuing eastward along I-395 through Southwest Washington, DC. Take right exit toward the U.S. Capitol and follow tunnel through Capitol Hill area to its termination at New York Avenue, NW; turn right at New York Avenue, bearing right immediately onto M Street, NW, and continue for three blocks to North Capitol Street. Turn left onto North Capitol Street and proceed northward for about 2 miles (past Michigan Avenue)

to its interchange with Irving Street. Take the Irving Street (west) exit and follow signs to the campus entrance.

- **From Montgomery County via Wisconsin or Connecticut Avenues**
  - From Wisconsin Avenue heading south, turn left onto Western Avenue (the District line) and take the first right onto Military Road. From Connecticut Avenue heading south, turn left onto Military Road. Follow Military Road almost 2.5 miles to the intersection of Georgia Avenue. Turn right on Georgia, then make a quick left onto Missouri Avenue. Continue on Missouri Avenue. Turn right on North Capitol Street. Follow North Capitol Street south to the Irving Street exit. Turn left at the first light onto the hospital campus.
- **From Baltimore/I-95**
  - Take I-95 south to I-495 west to Silver Spring (Capital Beltway). Take first exit at New Hampshire Avenue, south. Follow New Hampshire Avenue. Turn left onto North Capitol Street, south to Irving Street exit. Turn left at the first light onto the hospital campus.
- **From Baltimore/I-295**
  - Take the Baltimore/Washington Parkway (I-295) south. Follow signs to Washington. Exit to the right onto South Dakota Avenue. Follow South Dakota Avenue for about 2 miles. Turn left on Monroe Street, then turn left onto Michigan Avenue. Bear right onto Irving Street, west (just past the Shrine of the Immaculate Conception). Follow Irving Street. Turn left at the first light onto the hospital campus.
- **From Central or Southern Prince George's County, Anne Arundel County or Calvert County**
  - Take I-95 (Capital Beltway) to Exit 19B, Route 50 west. Exit to the right onto South Dakota Avenue. Follow South Dakota Avenue for about 2 miles. Turn left on Monroe Street, then turn left onto Michigan Avenue. Bear right onto Irving Street, west (just past the Shrine of the Immaculate Conception). Follow Irving Street. Turn left at the first light onto the hospital campus.
- **From Greenbelt/College Park/Hyattsville Area**
  - Follow Queen Chapel Road west through Hyattsville. Continue on Queens Chapel until it turns into Michigan Avenue. Continue on Michigan Avenue past the Brookland Metro Station and Catholic University. Bear right onto Irving Street, west (just past the Shrine of the Immaculate Conception). Follow Irving Street. Turn left at the first light onto the hospital campus.